

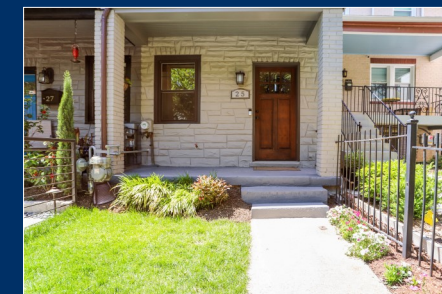

Stunning Fully Renovated Rowhome Located in Vibrant Southeast DC

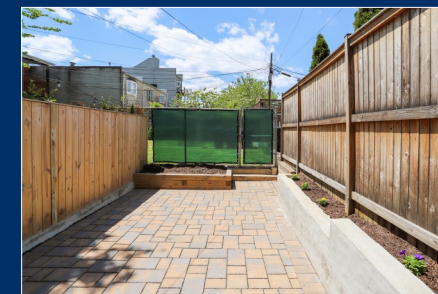

25 17th Street SE | Washington DC, 20003



CHRIS NAGEL

Ranked in the Top 3% of Realtors Nationwide

www.ChrisNagelHomes.com

Office: 301-340-8700 x155
Mobile: 301-787-8001
Chris@Coakleyrealty.com

Office: 301-340-8700 x103
Mobile: 301-814-3200
MPRose57@aol.com



MICHAEL P. ROSE

Ranked in the Top 1% of Realtors Nationwide

www.MichaelPRose.com



Stunning, fully renovated in 2015 brick 2BR/2.5BA Federal style row house located in vibrant Southeast DC. This home boasts approximately 1,232 square feet of comfortable living space on two levels featuring: custom painting, recessed and updated lighting, custom window treatments

and hardwood flooring.

Enter through the gated wrought-iron fully-fenced and freshly sodded front yard to the charming covered front porch. Versatile and open floorplan featuring living and adjacent dining room area both with hardwood flooring and recessed lighting; gourmet kitchen with stainless steel appliances, gas cooking, granite countertops and breakfast bar area, subway tile backsplash and pendant lighting; powder room and laundry/utility off kitchen with access to permeable paver patio and private fenced-in backyard; en-suite master bedroom suite with designer carpet, sliding double-door closet, ceiling fan with light and custom niche for tv; master bath with ceramic tile flooring, oversized vanity with granite countertop and subway tiled walk-in shower with listello border; spacious second bedroom with designer carpet, sliding double-door closet and ceiling fan with light; second full bath on upper level with ceramic tile flooring, vanity, and subway tiled tub/shower with listello border.

Close proximity to all the amenities that Capitol Hill and Hill East has to offer including the Washington Navy Yard, Eastern Market, Barracks Row, shopping, restaurants and two blocks from Metro Stadium-Armory access.



Chris Nagel



Michael P. Rose



Main Level

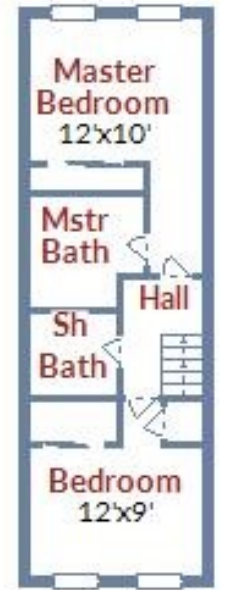

Upper Level



- Year Built:** 1900 (Fully Renovated 2015)
- Legal Subdivision:** Old City #1
- Est. RE Taxes:** \$4,410(FY 2020)
- Interior:** 1,232 Square Feet
- Exterior:** Brick
- Heat:** Gas (2015)
- Cool:** Electric (2015)
- Hot water:** Gas (2015)

- Elementary School**
Payne
- Middle School**
Eliot-Hine
- High School**
Eastern



Information in this brochure is deemed to be accurate, but should not be relied upon without verification.

